

THREE RIVERS DISTRICT COUNCIL

TRAFFIC REGULATION ORDER

2013 No.01

THE THREE RIVERS (VARIOUS ROADS INCLUDING COPTHORNE ROAD) CROXLEY GREEN (WAITING RESTRICTIONS) ORDER 2013

The Three Rivers District Council ("the Council"), pursuant to arrangements made under Section 19 of the Local Government Act 2000 and the Local Government (Arrangements for Discharge of Functions) (England) Regulations 2000 with the Hertfordshire County Council, and in exercise of the powers conferred on that County Council under Sections 1, 2, 3 and 4 and Part IV of Schedule 9 to the Road Traffic Regulation Act 1984 ("the Act of 1984") and of all other enabling powers, and after consulting with the Chief Officer of Police in accordance with Part III of Schedule 9 to the Act of 1984, hereby makes the following Order:-

1. This Order may be cited as The Three Rivers (Various Roads Including Copthorne Road) Croxley Green (Waiting Restrictions) Order 2013 and shall come into operation on 28th January 2013.

2. In this Order –

“The Council” means the Three Rivers District Council.

“Civil Enforcement Officer (CEO)” means a Civil Enforcement Officer appointed by the Council under Section 76 of the Traffic Management Act 2004.

“Disabled person’s vehicle” has the same meaning as in Section 142(1) of the Act of 1984.

"Disabled person's badge" and "parking disc" have the same meanings as in Regulation 3(1) of the Local Authorities' Traffic Orders (Exemptions for Disabled Persons) (England) Regulations 2000 and "relevant position" has the same meaning as in Regulation 4 of those Regulations.

“Universal service provider,” “Provision of a universal postal service” and “Postal packet” each has the same meaning as in the Postal Services Act 2000.

“Schedule” means a Schedule to this Order.

3. The Interpretation Act 1978 shall apply for the interpretation of this Order as it applies for the interpretation of an Act of Parliament.

4. Save as provided in Article 5 or 6 of this Order, no person shall, except upon the direction or with the permission of a Police Constable in uniform or with the permission of a Civil Enforcement Officer appointed by the Council, cause or permit any vehicle to wait on any length of road referred to in Schedule 1 to this Order at the times specified in Schedule 2 to this Order.
5. Nothing in Article 4 of this Order shall render it unlawful to cause or permit any vehicle to wait on any length of road referred to therein, for so long as may be necessary to enable –
 - (a)a person to board or alight from the vehicle;
 - (b)a person to load or unload the vehicle;
 - (c)the vehicle, if it cannot conveniently be used for such purpose in any other road, to be used in connection with any of the following operations, namely –
 - (i) ...building, industrial or demolition operations;
 - (ii) ...the removal of any obstruction to traffic;
 - (iii) ...the maintenance, improvement or reconstruction of the highway;
 - (iv)the laying, erection, alteration or repair in or adjacent to the said lengths of road of any sewer or of any main, pipe or apparatus for the supply of gas, water or electricity or of any electronic communication network within the meaning of the Communications Act 2003;
 - (d)the vehicle, if it cannot conveniently be used for such purpose in any other road, to be used in the service of a local authority or other authority in pursuance of statutory powers or duties;
 - (e)the vehicle to be used for the purpose of delivering or collecting postal packets by a “Universal service provider” as defined in the Postal Services Act 2000;
 - (f)the vehicle to be used for Fire and Rescue Service, Ambulance or Police purpose.
6. Nothing in Article 4 of this Order shall render it unlawful to cause a vehicle which displays in the relevant position a disabled person’s badge and a parking disc (on which the driver or other person in charge of the vehicle has marked the time at which the period of waiting began) to wait on any of the lengths of roads referred to in that Article for a period not exceeding three hours (not being separated by an interval of less than one hour from a previous period of waiting by the same vehicle on the same length of road on the same day), provided that such period lies entirely within the period during which loading is permitted in that location.

7. The restrictions imposed by this Order shall be in addition to, and not in derogation of, any restriction or requirement imposed by any regulation made or having effect as if made under the Act of 1984 or by or under any other enactment.

THE COMMON SEAL of THE THREE RIVERS DISTRICT
COUNCIL was hereunto affixed on
23 January 2013 in the presence of:

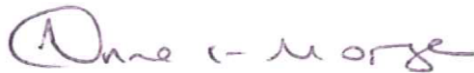

Solicitor to the Council



1/13

SCHEDULE 1 – Waiting Restrictions

| Item Number | Location | Restricted hours <i>refer</i> Schedule 2 |
|----------------|--|---|
| 01 | Barton Way, Croxley Green | |
| | The west side: From a point 10 metres south of the south kerbline of Fuller Way to a point 10 metres north of the north kerbline of Fuller Way. | A |
| 02 | Barton Way Recreation Ground access road (rear of 219 to 245, New Road service road), Croxley Green | A |
| | Both sides: except the north side between Barton Way and a point opposite the east (rear) boundary of 2, Barton Way and that length occupied by marked parking places. | A |
| 03 | Copthorne Road, Croxley Green | |
| | Both sides: From a point 10 metres west of the west kerbline of The Green east to its junction with The Green. | A |
| 04 | Fuller Way, Croxley Green | |
| | 04 a) Both sides: From its junction with Barton Way west to a point 10 metres west of the west kerbline of Barton Way. | A |
| | 04 b) (i) The north side: From a point 10 metres east of the east kerbline of Rugby Way west to a point 10 metres west of the west kerbline of Rugby Way. | A |
| | 04 b) (ii) The north side: From a point 10 metres east of the east kerbline of Repton Way west to a point 10 metres west of the west kerbline of Repton Way. | A |
| 05 | The Green, Croxley Green | |
| | 05 a) (i) The west side: From a point aligned with the north end of the marked parking place situated on the east (flank) boundary of 1, Windmill Drive north to a point 16.5 metres north of the north kerbline of Windmill Drive. | A |
| | 05 a) (ii) The west side: From a point 10 metres south of the south kerbline of Copthorne Road north to a point 10 metres north of the north kerbline of Copthorne Road. | A |

SCHEDULE 1 – Waiting Restrictions

| Item Number | Location | Restricted hours <i>refer</i> Schedule 2 |
|----------------|---|---|
| 06 | Repton Way, Croxley Green | |
| | Both sides: From the junction of Fuller Way north to a point 10 metres north of the north kerbline of Fuller Way. | A |
| 07 | Valley Walk, Croxley Green | |
| | Both sides: From its junction with Watford Road southeast to a point 15 metres southeast of the southeast kerbline of Watford Road. | A |
| 08 | Watford Road, Croxley Green | |
| | The southeast side: From a point 15 metres southwest of the southwest kerbline of Valley Walk to a point 15 metres northeast of the northeast kerbline of Valley Walk. | A |
| 09 | Windmill Drive, Croxley Green | |
| | Both sides: From its junction with The Green west to a point 20 metres west of the west kerbline of The Green. | A |

....end

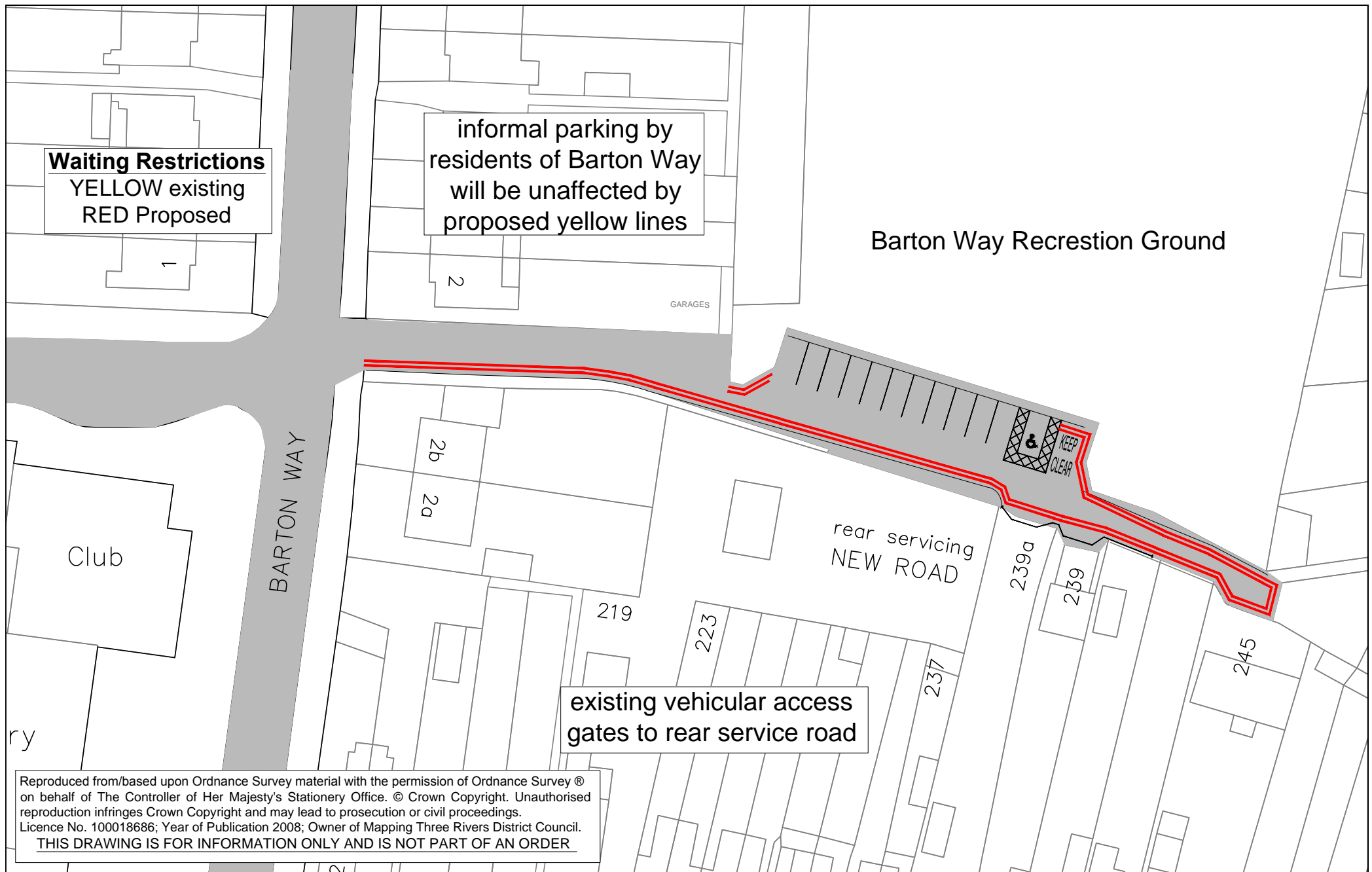

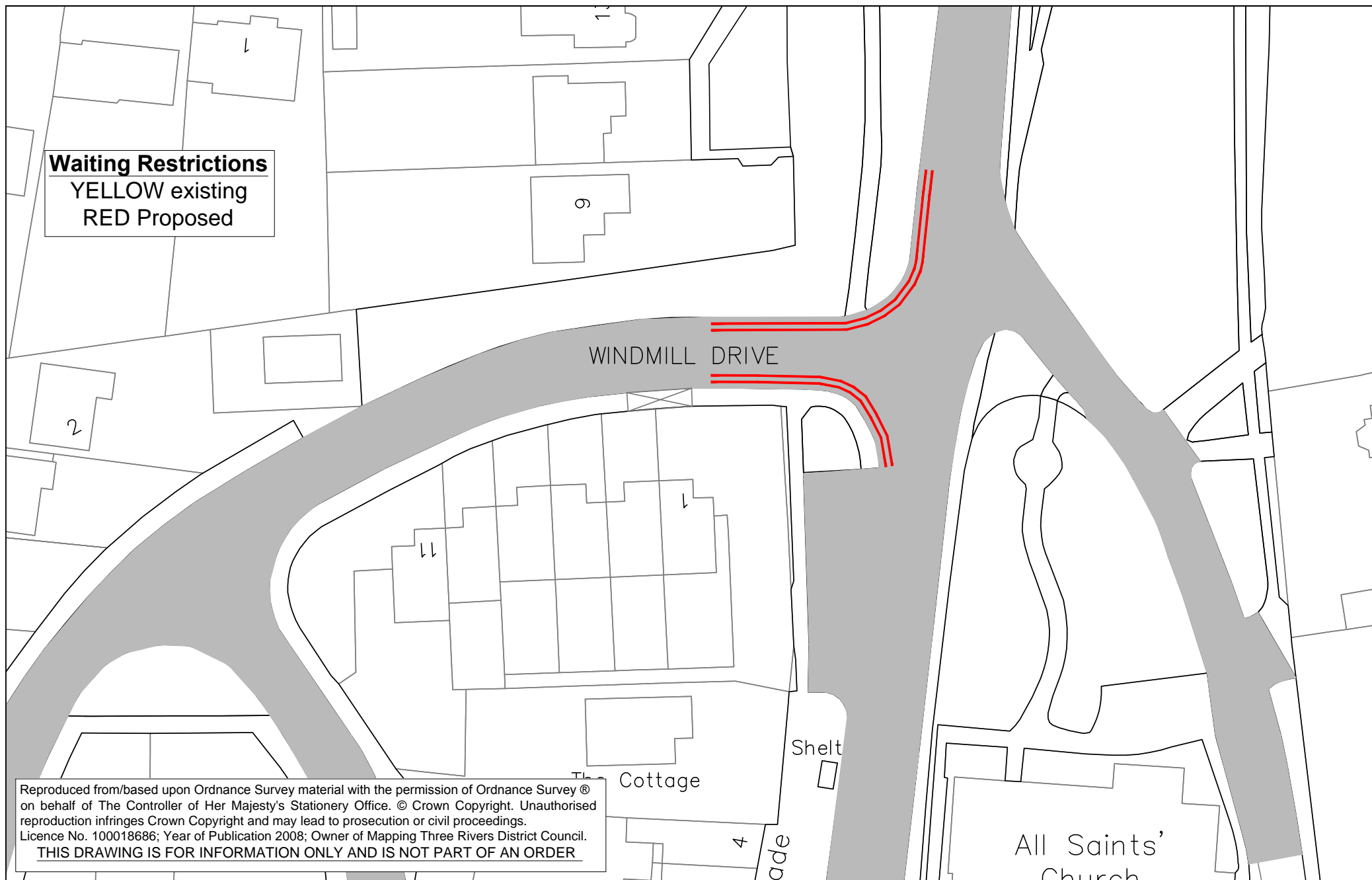

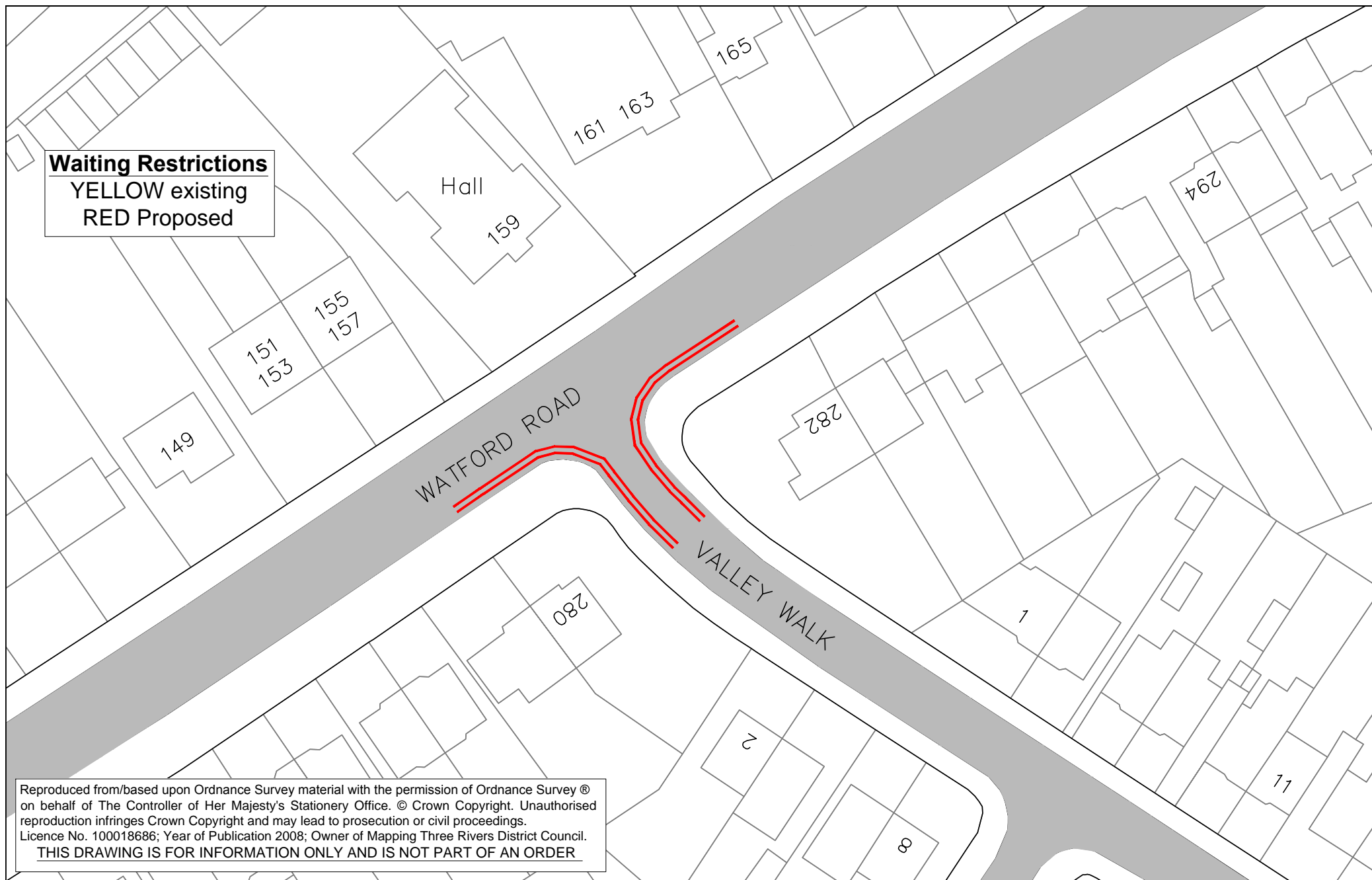

Waiting Restrictions
 YELLOW existing
 RED Proposed

